



# Venturi Flame

## Harmony Tabletop Fire Pit Setup and Operation

### Using Venturi Flame™ Technology & Gel Fuel

Read these instructions carefully for correct operation of your new table-top fire pit. Our table top fire pits run on clean-burning gel fuel. By simply adding our Venturi Flame fuel and glass cylinder, a stunning swirling fire appears. No valves, no fans, no problems!

#### Setting up the Harmony:

**Begin with the Harmony Base on a solid, stable platform out of reach of children and pets where it will not be bumped. Remove paper label and open gel fuel can lid with a screwdriver or paint can opener.**

**Using household glass cleaner, wipe down all glass surfaces before first use to remove any manufacturing residue before burning.**

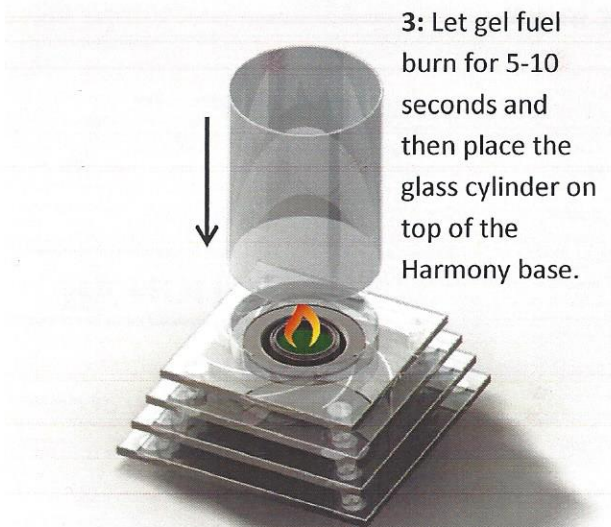
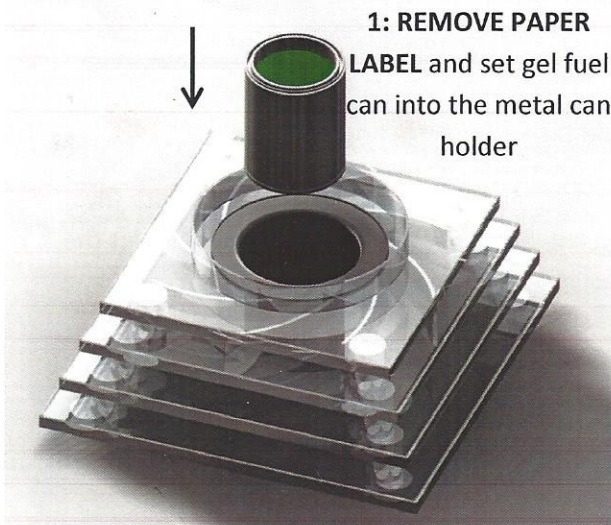

**IMPORTANT:** The Harmony should be permanently secured to the surface it operates on whenever possible to avoid accidental fire. See next page for securing instructions.